

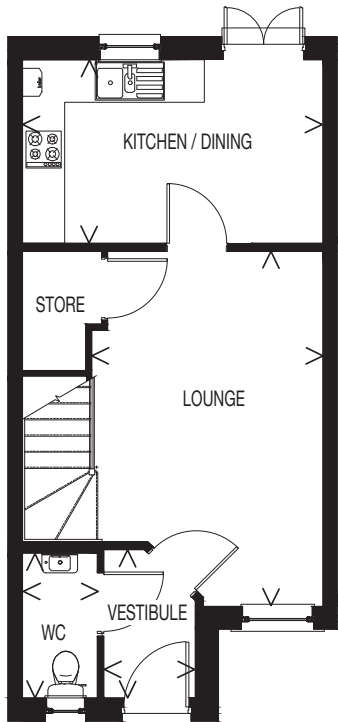

AILS A

2 BEDROOM TERRACED HOME

MuirTM
HOMES



GROUND FLOOR

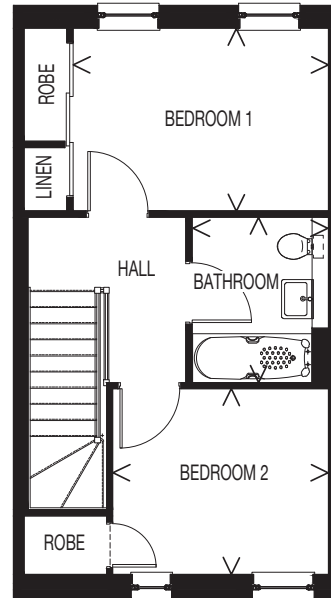

FIRST FLOOR

GROUND FLOOR

LOUNGE	3.26 x 5.02m	10'9" x 16'6"
KITCHEN/DINING	4.25 x 2.59m	13'11" x 5'6"
VESTIBULE	1.30 x 2.10m	4'3" x 6'11"
WC	1.06 x 2.05m	3'6" x 6'9"

FIRST FLOOR

BEDROOM 1	3.61 x 2.58m	11'10" x 8'6"
BEDROOM 2	3.05 x 2.62m	10'0" x 8'7"
BATHROOM	1.93 x 2.34m	6'4" x 7'8"